

CAF-Type (RoHS compliant products)

Introduction

High power ceramic resistors for various electronic and industrial equipment.
 A wire wound resistive element enclosed in special ceramic.
 A highly reliable resistor whose reliability is based on comprehensive quality control.

Features

1. Small-size, Large capacityA wire wound resistive element enclosed in special ceramic, smaller than other resistors of the same rating, and has higher mechanical strength.
2. Allows to save wiring laborStraight cord terminals reduce labor cost.

Type descriptions

CAF50 Style CAF50	(L250) Lead length code (L**):** is lead length When omitted, standard length 150mm is used.	100Ω Nominal resistance Ω or KΩ indication (E-24 series)	J Resistance tolerance J: ±5% K: ±10%
-------------------------	--	--	--

Load derating curve

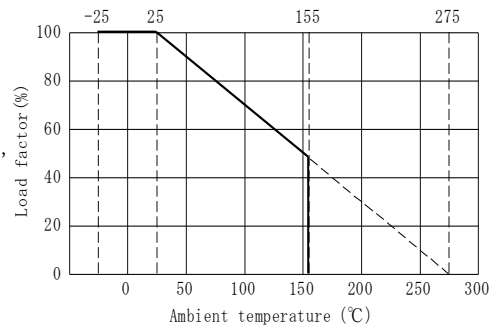

Temperature rise curve (reference)

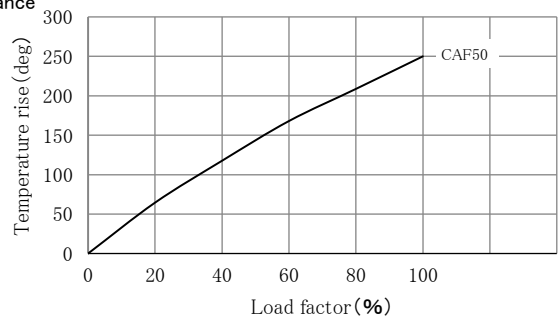

Dimensions & Resistance range

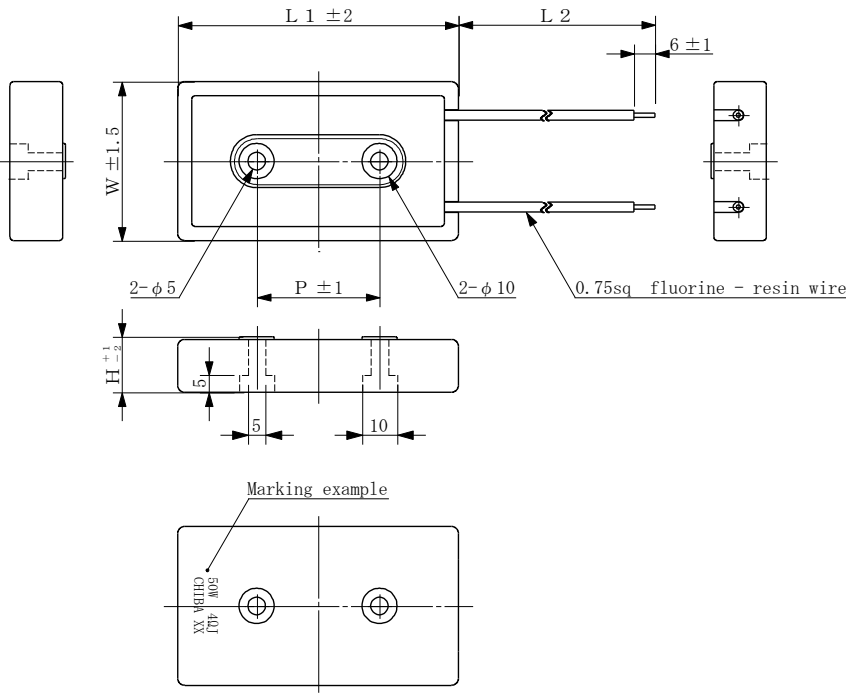

(*2)

Style	Power rating (W)	Resistance range (Ω)	Dimensions (mm)					Weight (g)	Customized product (*3)	
		Wire wound	L 1	L 2 (*1) Standard length	P	W	H		Thermal fuse	Thermostat
CAF50	50	1 ~ 1K	80	150	35	45	16	160	×	×

(*1) Standard lead length is 150mm (can be selected in 150-1000 range with 50mm step)

(*2) Resistance tolerance: below 1Ω:K(±10%), 1Ω and above:J(±5%)

(*3) Can be customized with special thermal fuse

(different from commercially available fuse) and thermostat(0:possible, X: not possible)